

# First Floor

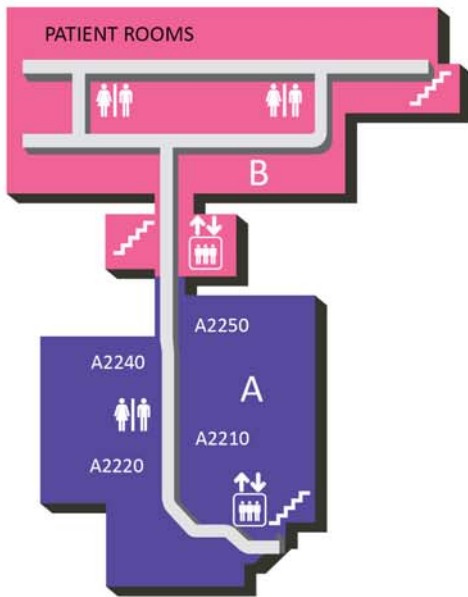

# Second Floor



## Departments

|                                       | Entrance | Room       | Floor |
|---------------------------------------|----------|------------|-------|
| Behavioral Health Unit                | Milling  | B3100      | 3     |
| Cardiovascular Institute of the South | South 1  | D1900      | 1     |
| Cath Lab                              | Milling  | C1501      | 1     |
| Imaging Services                      | North    | A1100      | 1     |
| Intensive Care Unit                   | Milling  | B1450      | 1     |
| Med/Surg Unit                         | Milling  | B2101-2131 | 2     |
| Ochsner Blood Donor Center            | North    | A1100      | 1     |
| Outpatient Registration               | North    | A1100      | 1     |
| Same Day Surgery                      | South 2  | G1810      | 1     |
| Surgery Waiting                       | South 2  | G1810      | 1     |

## Physician Offices

|                       | Entrance | Room  | Floor |
|-----------------------|----------|-------|-------|
| Birdsall, W., M.D.    | Milling  | B1402 | 1     |
| Brogie, B., M.D.      | South 1  | E1600 | 1     |
| Cecola, R.P., M.D.    | North    | A2210 | 2     |
| Chava, S. M.D.        | South 1  | D1900 | 1     |
| Devarajan, V.N., M.D. | North    | A2240 | 2     |
| Deubler, D., P.A.-C   | North    | A2250 | 2     |
| Hatfield, J., M.D.    | Milling  | B1402 | 1     |
| Hightower, L., M.D.   | Milling  | B1402 | 1     |
| Jaykrishnan, C., M.D. | North    | A2240 | 2     |
| Koppel, D. M.D.       | North    | A2210 | 2     |
| Mann, W.K., M.D.      | North    | A2250 | 2     |
| Paris, C., M.D.       | South 1  | D1900 | 1     |
| Raj, S., M.D.         | North    | A2210 | 2     |

### Key:

